

Regloplas accessories

Regloplas accessories cover all components for connecting the unit to the consumer, including heat transfer fluids, corrosion inhibitor and cleaners.

Regloplas accessories: Safety between temperature control unit and consumer.

Regloplas accessories are in exact accordance with our specifications – values that incorporate the experience gained over many years. Choose safety.



Fittings

Dimensions in mm if not specified otherwise.
 DN = Nominal width. SW = Spanner size.
 *DIN 3863: tapered sealing.

1. Adapter

d1*	d2	DN	SW	Order No.
M 14 x 1.5	R 1/2"	6	27	301-080114
M 14 x 1.5	R 3/4"	6	32	301-080118
M 16 x 1.5	R 1/2"	10	27	301-080113
M 16 x 1.5	R 3/4"	10	32	301-080117
M 18 x 1.5	M 14x1.5*	10	22	301-080115
M 18 x 1.5	M 16x1.5*	10	22	301-080112
M 18 x 1.5	R 1/2"	10	27	301-080110
M 18 x 1.5	R 1/2"	10	27	302-080108**
M 18 x 1.5	R 3/4"	12	32	302-080105**
M 26 x 1.5	R 3/4"	16	32	302-080106**

** Material 1.4301 (inox)

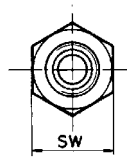
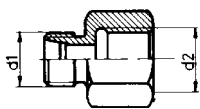

2. Adapter

d1*	d2	DN	SW	Order No.
M 14 x 1.5	M 10 x 1*	5	14	300-080128
M 14 x 1.5	R 1/8"	5	17	301-080129
M 14 x 1.5	R 1/4"	6	17	300-080127
M 14 x 1.5	R 1/2"	6	27	301-080138
M 18 x 1.5	M 10 x 1*	6	19	301-080125
M 18 x 1.5	M 10 x 1.5*	6	19	301-080139
M 18 x 1.5	M 16 x 1.5*	10	22	301-080126
M 18 x 1.5	R 1/8"	6	19	301-080120
M 18 x 1.5	R 1/4"	7	19	301-080121
M 18 x 1.5	R 3/8"	10	22	301-080122
M 18 x 1.5	R 1/2"	10	27	302-080119**
M 18 x 1.5	R 3/4"	12	32	302-080107**
M 26 x 1.5	R 3/4"	16	32	301-080124

** Material 1.4301 (inox)

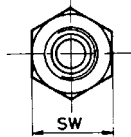
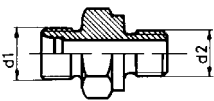

3. Adapter

d*	DN	SW	Order No.
M 16 x 1.5	8	19	301-080134
M 18 x 1.5	10	19	301-080130
M 26 x 1.5	16	32	301-080131

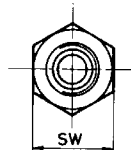
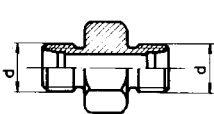

Further accessories on request

4. Dummy plug for hose fitting

d*	SW	Order No.
M 18 x 1.5	27	305-080140

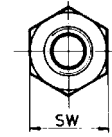
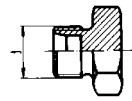

5. Elbow with cap nut

d*	α	DN	SW1	SW2	l1	l2	Order No.
M 18 x 1.5	45°	10	19	27	40	14	361-080150
M 18 x 1.5	90°	10	19	27	38	35	361-080151
M 26 x 1.5	90°	16	27	32	55	53	361-080153

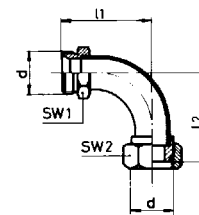
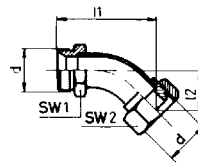

6. Adapter with cap nut for filters, twin connectors, ball cocks, etc.

d1*	d2	DN	SW1	SW2	Order No.
M 18 x 1.5	R 3/8"	10	22	22	301-080164
M 18 x 1.5	R 1/2"	10	22	27	302-080166**
M 18 x 1.5	R 3/4"	10	22	32	302-080169**
M 26 x 1.5	R 3/4"	16	32	32	301-080167

** Material 1.4301 (inox)

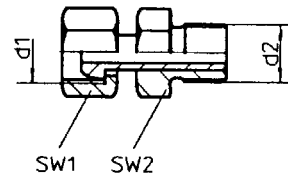

7. Adapter with cap nut for 'Hasco' standard parts.

d1*	d2	DN	SW	Order No.
M 18 x 1.5	M 14 x 1.5	10	22	301-080170
M 18 x 1.5	M 16 x 1.5	10	22	301-080171

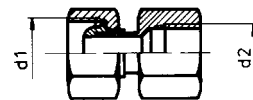

8. Adapter for cooling water hoses

d1	d2	DN	Order No.
R 3/8"	14.5	13	300-080184
R 1/2"	17.5	16	300-080185

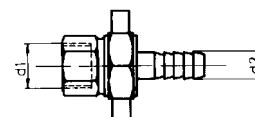

Hoses

1. Fabric-reinforced perbunane/neoprene hose for water up to 70°C and oil up to 120°C

d*	DN	l (m)	SW	Order No.
M 14 x 1.5	6	0.6	17	362-080213
M 14 x 1.5	6	2.5	17	362-080214
M 18 x 1.5	10	0.6	24	362-080211
M 18 x 1.5	10	2.5	24	362-080212

2. PTFE hose for water up to 200°C and oil up to 250°C. Stainless steel jacket.

d*	DN	l (m)	SW	Min. permiss. bending radius	Order No.
M 18 x 1.5	10	0.6	22	120	362-080250
M 18 x 1.5	10	2.5	22	120	362-080252
M 26 x 1.5	16	0.8	32	165	362-080251
M 26 x 1.5	16	2.5	32	165	362-080253

3. All-metal hose with steel jacket. For oil up to 350°C. Without heat insulation.

d*	DN	l (m)	SW	Min. permiss. bending radius	Order No.
M 18 x 1.5	10	0.6	22	140	362-080260
M 18 x 1.5	10	1.5	22	140	362-080264
M 18 x 1.5	10	2.5	22	140	362-080262
M 26 x 1.5	16	1.0	32	175	362-080261
M 26 x 1.5	16	2.5	32	175	362-080263

4. All-metal hose with braided steel jacket. For oil up to 350°C. With heat insulation (no protection against contact).

d*	DN	l (m)	SW	Min. permiss. bending radius	Order No.
M 18 x 1.5	10	2.5	22	155	362-080272
M 26 x 1.5	16	2.5	32	175	362-080273

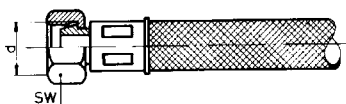

Quick-connect couplings

1. Quick-connect coupling for water up to 100°C and oil to 200°C. Viton gasket. Shut-off in both directions.

d1*	d2	DN	l	Description	Order No.
M 18 x 1.5	38	8	69	Socket	465-080320
M 18 x 1.5	34	8	47	Plug	465-080321
M 26 x 1.5	38	16	71	Socket	465-080322
M 26 x 1.5	34	16	49	Plug	465-080323

2. Quick-connect coupling for water up to 170°C. EP gasket. Shut-off in both directions.

d1*	d2	DN	l	Description	Order No.
1/2"	40	12	81	Socket	465-080744
1/2"	40	12	79	Plug	465-080745

Further accessories on request

3. Quick-connect coupling for Oil up to 200°C. Special gasket. Shut-off in both directions.

d1*	d2	DN	l	Description	Order No.
M 18 x 1.5	40	12	77	Socket	465-080330
M 18 x 1.5	40	12	78	Plug	465-080331
M 26 x 1.5	54	15	95	Socket	465-080332
M 26 x 1.5	54	15	94	Plug	465-080333

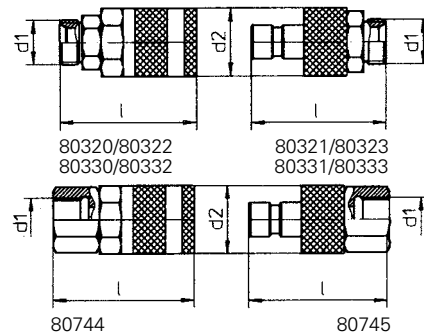

Ball cocks/Manifolds

1. Ball cock for water and oil up to 180°C. PTFE gasket.

d	DN	l	SW	Order No.
R 3/8"	10	55	24	351-100073
R 1/2"	12	65	29	351-100013
R 3/4"	20	72	33	351-100057
R 1 1/2"	40	110	57	351-100012

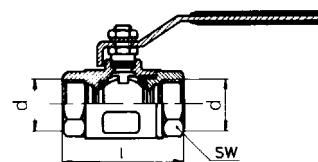

2. Ball cock for oil up to 300°C.

d	DN	l	SW	Order No.
R 1/2"	15	85	32	351-080430
R 3/4"	20	95	41	351-080431

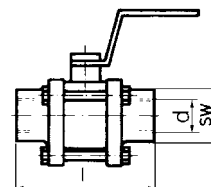

3. Twin connector without valves for water up to 160°C and oil up to 300°C.

d1*	d2*	DN	l	Order No.
M 18 x 1.5	M 18 x 1.5	10	60	351-080510
M 18 x 1.5	M 26 x 1.5	10	60	351-080511
M 26 x 1.5	M 26 x 1.5	16	60	351-080512

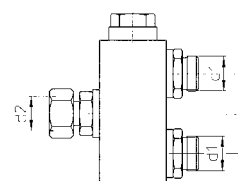

4. Twin connector with ball cocks for water and oil up to 180°C.

d1*	d2*	DN	l	Order No.
M 18x1.5	M 18x1.5	10	60	351-100083
M 18x1.5	M 26x1.5	10	60	351-100084
M 26x1.5	M 26x1.5	16	60	351-100085

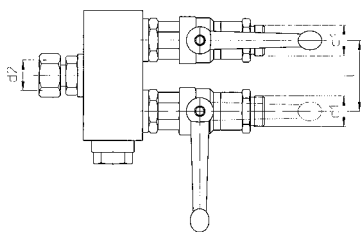

5. Twin connector with ball cock for oil up to 300°C.

d1*	d2*	DN	l	Order No.
M 18x1.5	M 18x1.5	10	60	351-080540
M 18x1.5	M 26x1.5	10	60	351-080541
M 26x1.5	M 26x1.5	16	60	351-080542

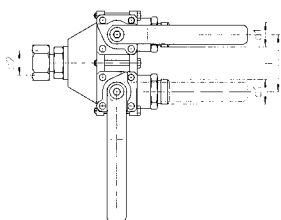

Filling port

For corrosion inhibitor RK93.

d1	d2	SW1	SW2	L	Order No.
M 18x1.5	1"	27	22	119.5	361-080700

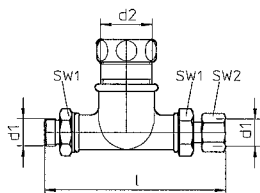

Filters

1. Angled filter for water and oil up to 160°C. Approx. 0.25 mm mesh.

d	l	h	SW	Order No.
R 3/8"	55	40	21	352-100008
R 1/2"	58	40	21	352-100010
R 3/4"	70	50	27	352-100011
R 1"	87	60	32	352-100012
R 1 1/4"	96	68	36	352-100017
R 1 1/2"	106	75	40	352-100018

Further accessories on request

2. Angled filter for oil up to 300°C. Approx. 0.56 mm mesh.

d	l	h	SW	Order No.
R 1/2"	90	60	36	352-064331
R 3/4"	110	75	41	352-064332

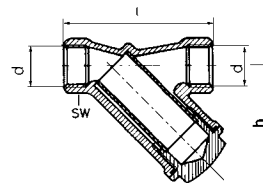

Flow meters

Type F150: For water and oil up to 150°C.

Range 2 to 50 l/min. G3/4".

1. With control system RT100:

Order No. MP2112.

2. With controller:

With separate display RDA50.

Order No. 153-065210 + 153-065215.

Type F181: For water up to 180°C.

With control system RT100.

Range 2 to 50 l/min. G1/2".

Order No. MP2114.

Type F185: For water up to 180°C.

With control system RT100.

Range 20 to 280 l/min. G1".

Order No. MP2115.

Type F351: For oil up to 350°C.

With control system RT100.

Range 2 to 50 l/min. G3/4".

Order No. MP2113.



F150

F181; F185

F351

Flow indicator

Flow indicator with ball, for water and oil up to 150°C.

d	l	Order No.
R 1/2"	68	153-080710
R 3/4"	75	153-080711

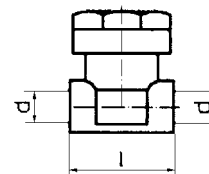

Interconnecting system (insulating channels)

Max. operating temperature 300 °C.
Max. pressure 16 bar.

Item	Description	Order No.
1	Channel with 4 tubes, L = 1 m Channel with 4 tubes, L = 2 m Channel with 4 tubes, L = 2.5 m	480-080635 480-080636 480-080637
2	Elbow	480-039162
3	Adapter M 30/24° – M 18/60° for connections of channel to hose M 26 x 1.5	301-080809
3a	Adapter M 30/24° – M 18/60° for connection of channel to hose M 18 x 1.5	301-080816
4	Angled coupling W 22-PL for inter-connection of channel	305-068107
5	Angled coupling, EVW 22-PL for connection of channel to hose	305-068120
6	Straight coupling G 22-PL	305-068035
7	Hose M 26 x 1.5 bzw. M 18 x 1.5	Page 26, item 2–4

Advantages

- Reduction of heat losses over long distances between consumer and temperature control unit.
- Increased safety: Tubes are sturdier than hose lines.
- Savings in time and costs: Instead of building the installation yourself, a complete connection system including screw couplings, hoses, etc. is at your disposal.

Remarks

For safety reasons and in order to compensate for expansion due to heat, we recommend using heat-insulated all-metal flexible tubes for high temperatures between temperature control unit, insulating channel and insulating channel-consumer. Depending on the temperature, suitable heat-insulated plastic tubes can also be used.

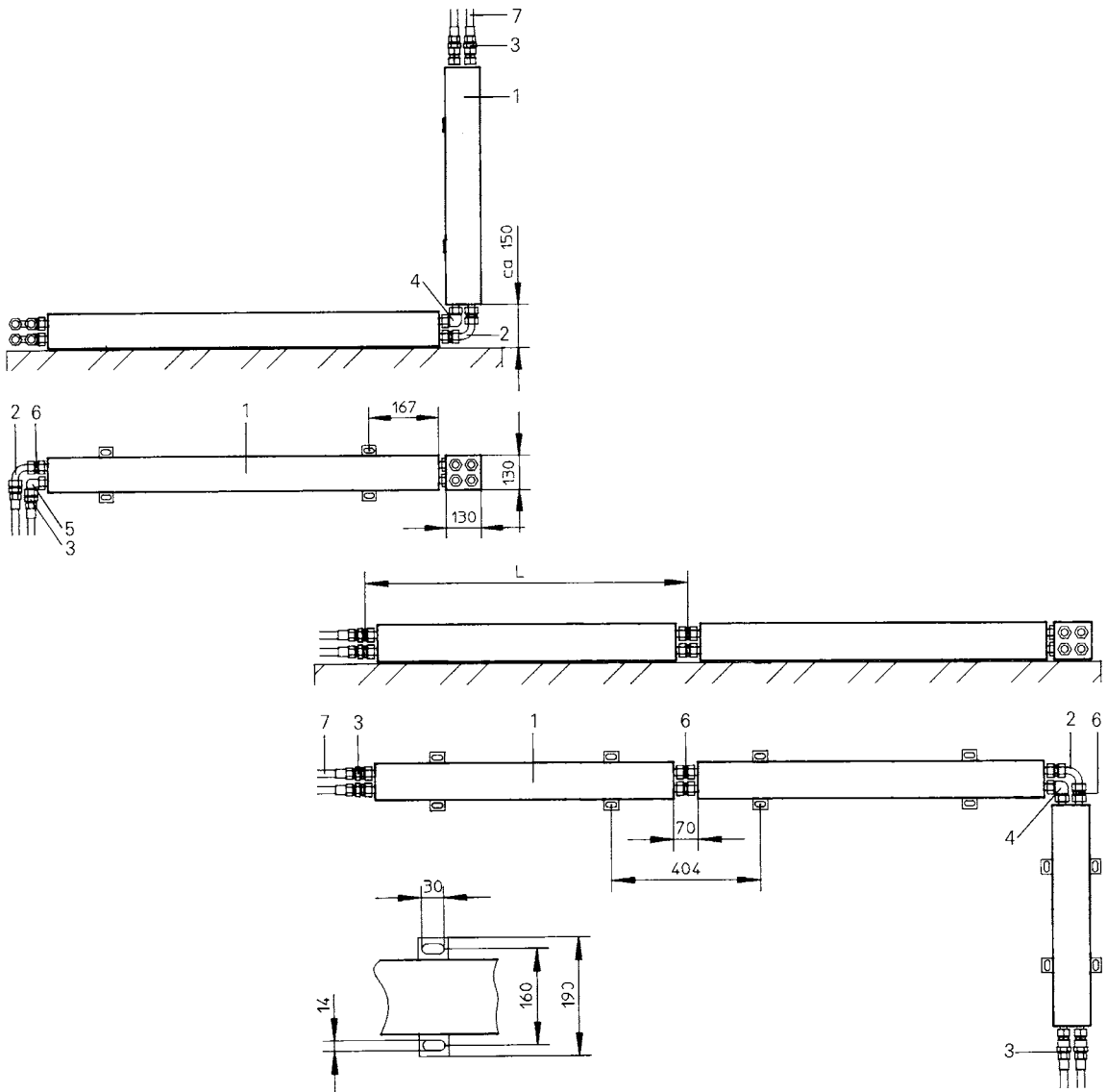

Further accessories on request

Temperature sensors

Type	Resistance thermometer		Thermocouple		
	Standard	Variable mounting depth	Standard	Variable mounting depth	Mineral-insulated
Measuring element	1 x Pt100 (DIN)		J (Fe-CuNi) DIN or K (NiCr-Ni) DIN		
Continuous temperature	400 °C		400 °C		
Insulation of wire	Silicon-impregnated glass-fibre		Silicon-impregnated glass-fibre		
Shielding of cable	Steel braid		Steel braid		
Material of the measuring sleeve	St V 2 A	Brass	St V 2 A		
Dimensions	Fig. 1	Fig. 2	Fig. 3	Fig. 4	Fig. 5
Example for ordering	Standard-sensor Pt100 No. 151-046110	Sensor with variable mounting depth Pt100 No. 151-046120*	Standard-sensor J (Fe-CuNi) No. 151-046112 K (Ni-CrNi) No. 151-046062	Sensor with variable mounting depth J (Fe-CuNi) No. 151-046122* K (Ni-CrNi) No. 151-046063*	Mineral-insulated thermocouple J (Fe-CuNi) No. 151-046180 K (Ni-CrNi) No. 151-046185
	Notes *Bayonet coupling No.151-046200 included (Fig. 4)				

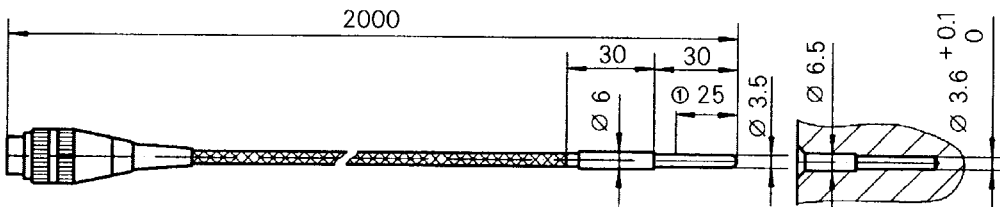

Fig. 1: Standard sensor (plug Pt100)

① Active zone of sensor Pt100

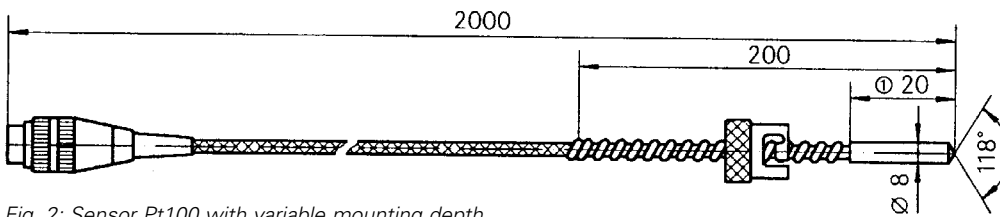

Fig. 2: Sensor Pt100 with variable mounting depth

① Active zone

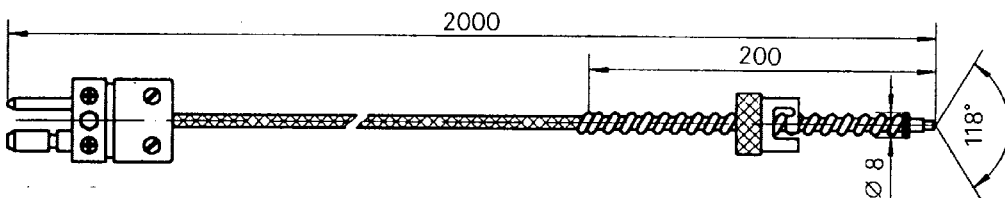

Fig. 3: Sensor with thermocouple

Further accessories on request

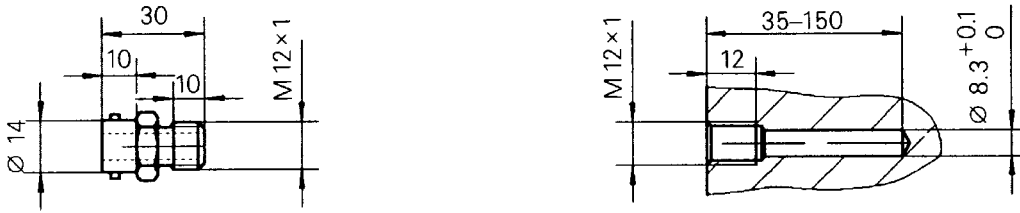

Fig. 4: Bayonet coupling and drilling scheme

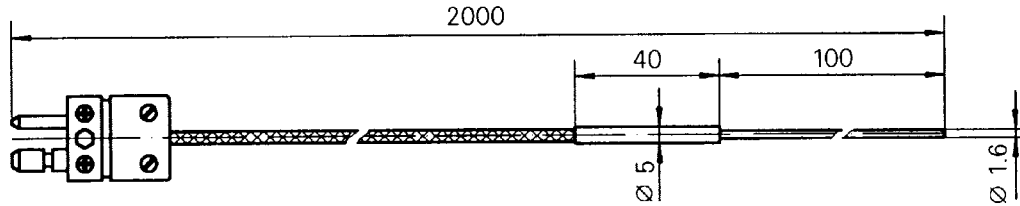

Fig. 5: Mineral-insulated thermocouple

Drilling diameter 1.7 mm

Accessories for interface

Cable and plug upon request.

Operating material

Heat transfer fluids

1. Synthetic thermal oil RO150. For units with max. outlet temperatures of 200 °C.

Unit	Order No.
20 l can	451-081014
200 l barrel	451-081015

2. Synthetic thermal oil RO300. For units with max. outlet temperatures of 340 °C.

Unit	Order No.
20 l can	451-081022
200 l barrel	451-081021

3. Synthetic heat transfer fluid RO200. For units with max. outlet temperatures of 200 °C. Cannot be mixed with thermal oil.

Unit	Order No.
20 l can	451-081030
200 l barrel	451-081031

Descaling agent REM93

For descaling unit REG.

Unit	Order No.
1 kg	451-081211

Corrosion inhibitor RK93

For units with water as heat transfer fluid.

Unit	Order No.
1 l can	451-081125
5 l can	451-081126
30 l can	451-081129
Test set for checking concentration	451-081130

System cleaner SR80

For units with thermal oil RO150/RO300 as circulating fluid.

Unit	Order No.
1 l can	451-081310
5 l can	451-081311

Further accessories on request